

Praise and Prayer points for the Nigeria Christian University Project

Denise and I have safely returned to the US after an extended stay in Nigeria. Shortly after James' return, he flew to Atlanta to join Professor Maxey for four days of meetings with various ministry partners. We are pleased to report that we are seeing God's provision of both personnel and funding. Three key project areas are highlighted below. The first, we are on track to meet our first capital fund milestone for the university, funding construction of the first building that will be used for the university. The second, we are making good progress on the expansion of Providence Vocational Academy's programs. Lastly, we will be opening our processing center at the Agricultural Industrial Park in the near term.

First Building for University: The initial home for the university will be at Providence Center. The university will utilize the three-building complex shown below. The complex will house university administration offices and classrooms. Based on the kind of response we are receiving from supporters, we anticipate raising an additional \$100,000 before the end of the year, allowing us to start construction of the first building early next year.

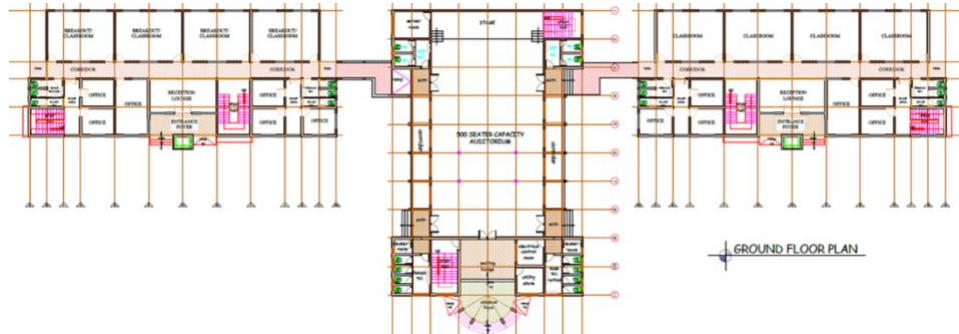

Providence Vocational Academy Program Expansion: In addition to the agricultural and IT hub and programs we have discussed previously, we are adding programs in construction skills (plumbing and electrical / solar). Our programs have been approved by Ogun State, allowing students to qualify for support provided from World Bank funding. Shown below are students in the current cohort; in the center, Dr Eric Ighalo leads a session in the area of spiritual formation, a key aspect of the Academy.



Industrial Park Processing Center Construction of Phase I of the processing center has been completed, as shown on the far right above. Once furnished we will be seeking FDA registration to facilitate export of products to Canada and the US.

KEY PRAYER REQUESTS

- **Progressing University:** Continue progress on 'road maps' for establishing initial faculties, particularly in the areas of education and agriculture, and our partnership with WATS. Funding for first building.
- **Land:** Title for the 1st & 2nd tracts. Kickoff of Community Advisory Group; help with encroachment issues.
- **Staff and Faithful Supporters:** prayer support, volunteers, missionaries, funding.
- **Please pray for full restoration of Kabiyesi's health (the King of Imala).** Kabiyesi continues to recover his strength after a week in the hospital and further rest at home.

We are so thankful for those joining us in prayer; we recognize we are in a spiritual battle (Eph 6:12), a battle that can only be won through prayer! We ask that you especially pray on the 20th of the month.

Thank you for your support,
James Rose (CDF President, Project Lead)

Email: CDF@CDFAFRICA.org

CDF Website: <http://cdfafrica.org>

Please note that contributions can be made to CDF direct deposit using Zelle via our email: CDF@CDFAFRICA.org. Alternatively, make checks payable to Christian Development Foundation and mail to 6317 Estates Lane, Fort Worth Tx.